

Our Range

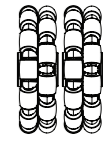
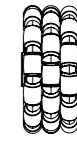
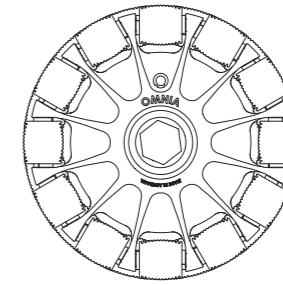
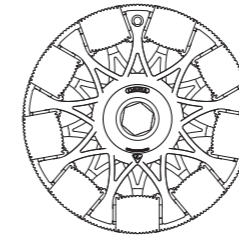
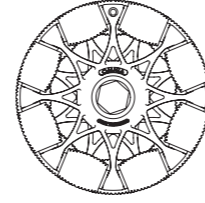
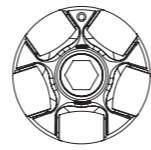

R2

R3

R4
(2xR2)

Diameter	35mm		50mm		90mm		127mm			150mm			180mm		
Core part number	R2-0354		R2-0504		R2-0905		R2-1278			R2-1509			R2-1801	R3-1801	
Roller Hardness (Shore A) Colour	57	99	74	74	95	74	74	95	74	85	95	74	85	95	
Load Capacity (Kg)**	2	5	15	25	50	90	60	100	110	70	105	125	R2 75	R2 120	R2 135
Net Wheel Weight (g)	12	13.5	40	40	195	195	335	355	360	490	510	515	R2 760	R2 790	R2 795
Bearing Seat/Bore	8		14		19		19			19		19		25.4	
Bearing seat	8mm keyed / 8mm plain		16x5mm		28x8mm		28x8mm			28x8mm		35x11mm		42x12mm	
Inner bore	8mm keyed / 8mm plain		14mm Hex		19mm Hex		19mm Hex			19mm Hex		19mm Hex		25.4mm hex	
Hub Width (mm)	18.5		27.5		43		51 / 53*			51 / 53*		52		57 (R2)	85 (R3)

Legend:

Imperial ID Sizing

05	3/16"
09	3/8"
11	7/16"
13	1/2"
13+	1/2"+
16	5/8"
19	3/4"

Bearing/Bush Profile

H	Hex
S	Round
D	Round
HR	Rotating hex
LX	LEGO
VX	Vex 1/8" square

Bearing/Bush Material

A	ABS
D	Acetal
S	Sealed (steel) bearing

*With raised inner race Omnia bearing.
 **The (maximum recommended) load capacities apply to manual applications. For powered or constant duty use, please enquire.

Bearings/Bushings

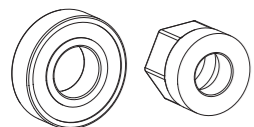

Drive Inserts

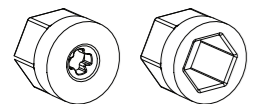

Mounted Options

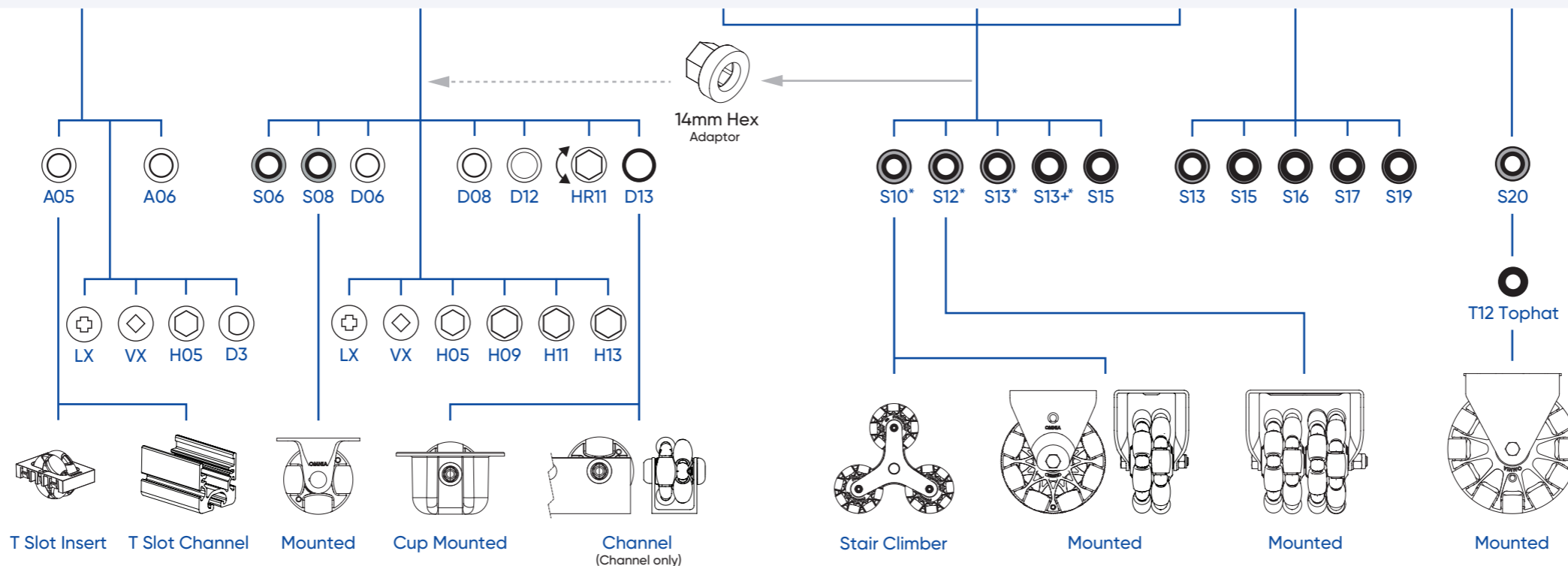

Looking for a custom solution?

Contact our Team
sales@omniawheel.com

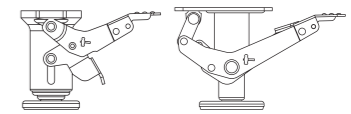

Floor Locks/Brake